

变更标记	日期	变更内容	签名	核准

Material & finish

SHELL:
 steel
 Zinc plated, Tin plated
 or Nickel plated steel
 PIN CONTACT:
 Phosphor bronze or brass
 Gold Plated
 INSULATOR:
 PBT & Glass-fibre reinforced
 UL-94-V0
 NUMBER OF CONTACT:
 15 26 44 62
 CURRENT RATING:
 3Amp
 INSULATOR RESISTANCE:
 1000Mh MIN.(at 500V DC)
 TEMPERATURE:
 -55°C to +105°C

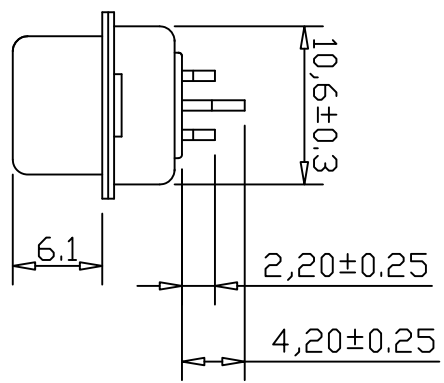
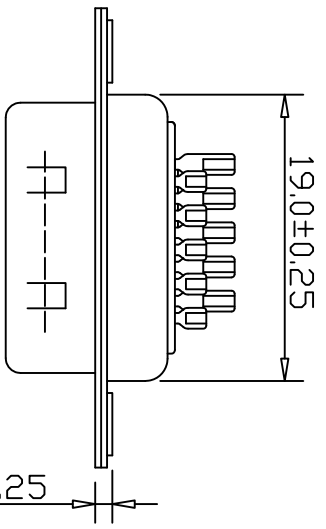
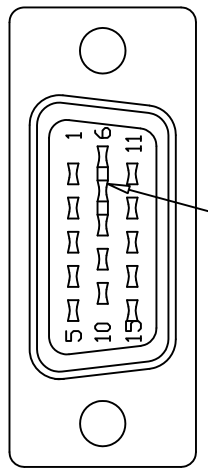

HD-15 T x V x x x A 0 0

Pin: 15 26 44 62
 COLOUR
 B: Blue K: Black W: White 2: 661C
 blue 3: 235C Red 4: 322C green
 6: 1310 Yellow

SHELL PLATING
 A: Gold B: Front Gold and back Tin C: Front Nickel and
 Back TIN N: Nickel T: Tin 5: Zinc D: CU/ZN/NSN
 Contact Finish
 A: Gold Flash C: Gold Flash3U" D: Gold Flash5U" E: Gold Flash15U"
 F: Gold Flash30U" 6: Gold T: Tin

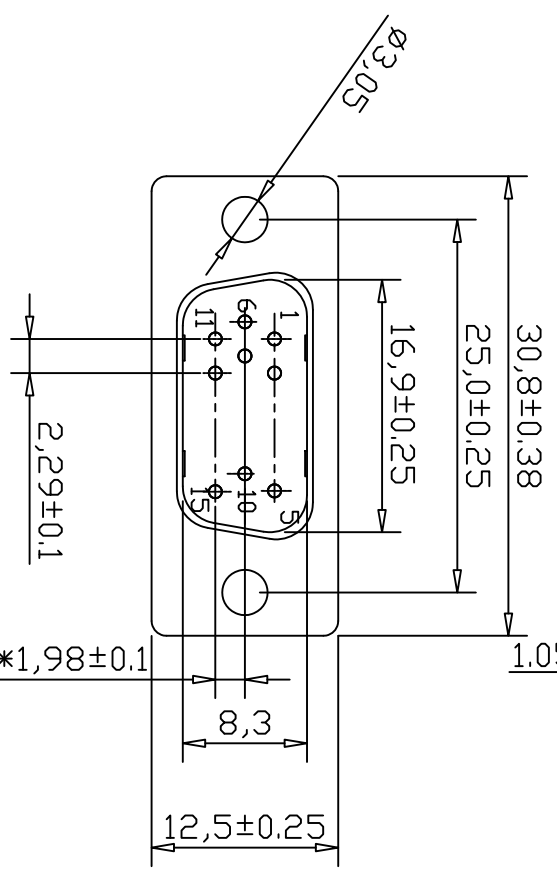

东莞扬顺五金电子有限公司

Dong Guan City Yang Shun Hardware Electron Co., Ltd

未注公差	X. ±0.30	设计	雷永兴	品名规格	HD-15公一体公实心PIN焊线式 6, 7, 8PIN短路
X.X ±0.20	审核	料号	HD-15T×V×××AA0	型号	D-SUB 15Pin
X.XX ±0.10	单位	日期	2012.09.03	图号	YS-11-0042
X.XXX ±0.05	比例	1:1	版次	A/0	
X.° ±2° X.X° ±1°					